

Mimitakara® Rechargeable ITC Hearing Aid (Dual)

ACCESSORIES

1. Charging Case x 1
2. Hearing Aid x 2
3. Earbuds (Tiny*2,
Small*2, Medium*2,
Large*2)
4. Cleaning Brush x 1
5. AC Adapter



FEATURES

■ Hearing Aid

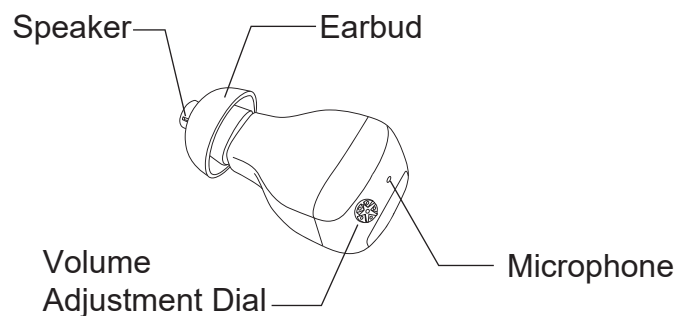

■ Charging Case

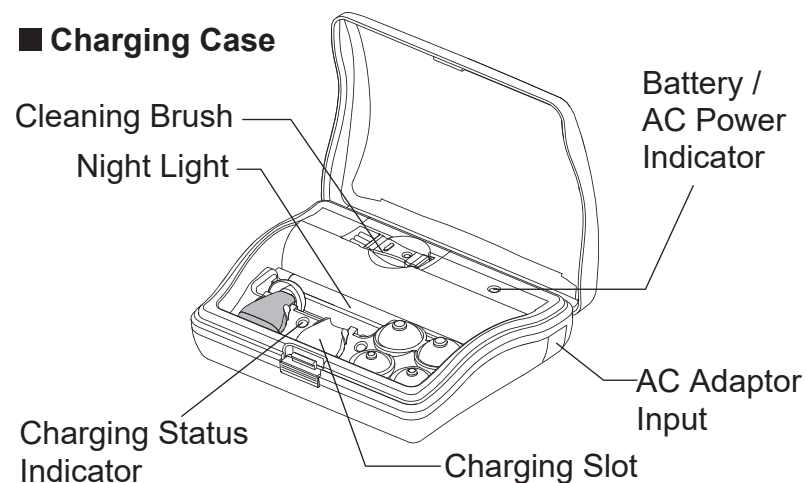

OPERATING INSTRUCTION

*Note: Prior to using your hearing aid, make sure that the unit is fully charged.

Step 1.

Switch ON the aid by rotating the volume adjustment dial clockwise.

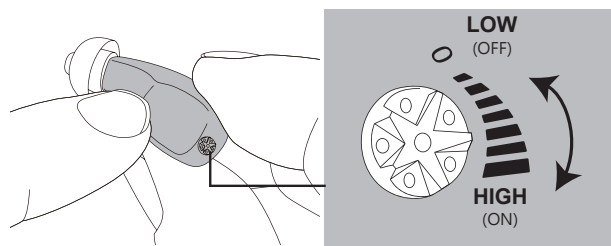

Step 2.

Make sure the earbud is securely attached to the hearing aid.

Step 3.

Use your finger to cover the microphone hole, then gently insert the hearing aid inside your ear.

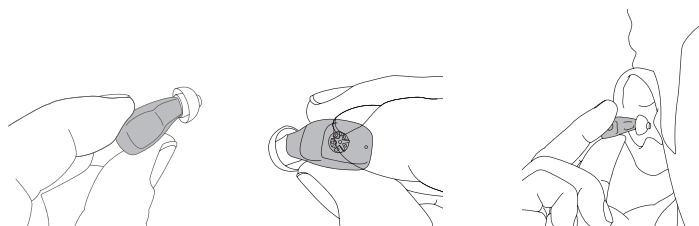

Step 4

Use the volume adjustment dial to adjust the volume to comfortable level. Rotate clockwise to increase the volume and counter-clock wise to reduce the volume.

CHARGING INSTRUCTION

There are two different methods to charge the hearing aid (Charging by Battery or AC Adapter):

Step 1.

Make sure the hearing aid is switched ON

(The volume adjustment dial is not set in the Low / Off position)

Step 2.

Place the hearing aid vertically on the charging slot as shown.

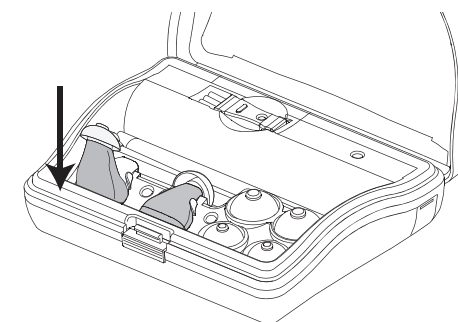

Step 3.

Lay the hearing aid down by gently pushing the aid towards the charging case cover as shown.

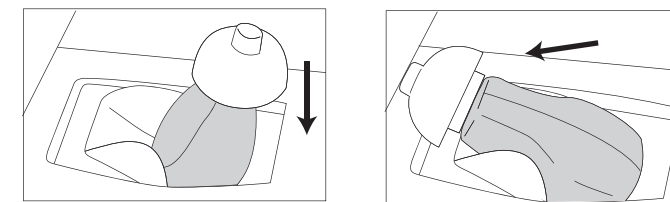

Step 4.

Insert AAA batteries or plug in the AC Adapter.

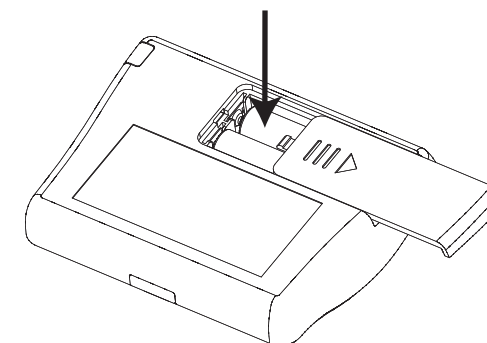

Step 5.

Ensure that the night light is ON and the hearing aid is sit properly in the charging case.

Consult the status indicator lights to confirm whether the hearing aid is charging normally.

Close the charging case cover to protect the hearing aid from dust and damage.

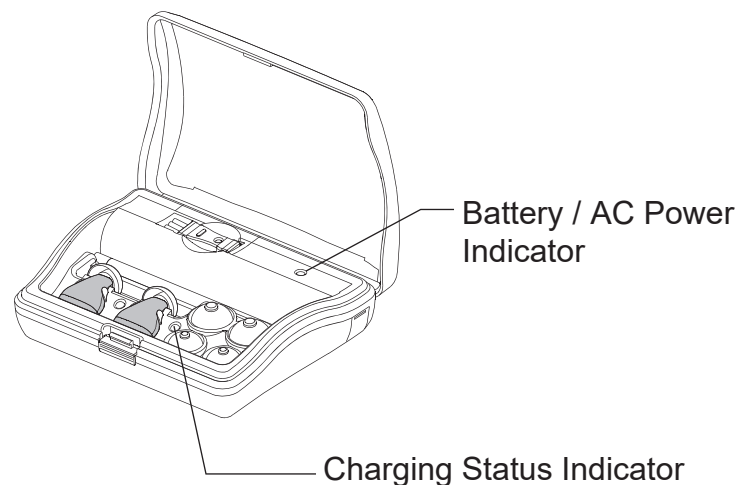

INDICATOR LIGHT STATUS

| | | |
|------------------------------|-------|--|
| Charging Status Indicator | GREEN | Hearing aid is charging normally |
| | OFF | Hearing aid is fully charged (or Hearing aid is not correctly inserted in the charging case) |
| Battery / AC Power Indicator | GREEN | Power supply is normal |
| | RED | AAA batteries power is low (insert new AA battery or use AC adapter) |
| | OFF | No power (insert new AAA batteries or use AC adapter) |

REPLACING EARBUDS

We provide earbuds of three different sizes to suit your need. To replace the earbud:

Step 1.

Gently pinch the earbud and pull it off.

You should see an axis coming out from the earbud.

Step 2.

Pick the replacing earbud. Align to the central hole of the earbud tip with the axis and gently push the tip toward it until the earbud is fully inserted onto the axis.

CLEANING INSTRUCTION

Before & After each use

Step 1.

Remove the earbud from the hearing aid gently.

Step 2.

Use the cleaning brush to clean any earwax adhered on the hearing aid, especially in the area around the earbud tip.

Step 3.

Securely attach the earbud back on the hearing aid with care.

BATTERY INSTRUCTION

- When the battery is low on the hearing aid, an audible sound will alert the user that the battery is low and needs to be charged.
- A full charge takes about 8-12 hours, and will allow for up to 6-10 hours of usage.
- The rechargeable battery is designed to last for at least 500 recharge cycles. Afterwards, the battery will need to be serviced and/or the hearing aid replaced. With proper care, the battery can last for up to and beyond 1000 charge cycles.
- To extend usage life of the battery, keep the hearing aid in its case and charging when not in use.
- Make sure you switch ON the aid before charging.

NOTICE

- To extend the rechargeable battery life, fully charge the hearing aid and then switch off when not in use for a long period of time.
- Keep both your ears and the hearing aid, free from earwax.
- With proper care, the rechargeable battery can last for up to, and beyond, 500 charge cycles.
- When the rechargeable battery is low, the sound becomes quieter. This means the battery is low, and needs to be charged.
- Keep this product away from infants, children and pets.
- Prior to first use, read instructions carefully to ensure proper operation, care and handling of your hearing aid.
- Do NOT use this product under the following conditions : operating mobile phone, sleeping, showering, washing your hair / face, swimming, or any vigorous exercise, to avoid damage to the hearing aid or you.

SPECIFICATION

| |
|--|
| Standard Frequency : 1600 Hz |
| Max. Output Sound Level Gain : 40 ± 5dB |
| Highest Sound Pressure Level for Input SPL 90dB : 118 ± 5 dB |
| Total Harmonic distortion value : |
| 2500Hz below 3% / 800Hz below 4% / 500Hz below 4% |
| Battery Current Drain : Below 0.55mA / 2.5V |
| Battery Type / Life Expectancy: Button Size Rechargeable Battery |
| Continuous Use: 7~12 hours per charged |
| Size(L/W/H) : Hearing Aid : 10.5 x 14.4 x 24.0 mm |
| Charging Case: 96.0 x 73.0 x 30.0 mm |
| Weight : <Hearing Aid> 2.4g / <Chargeable Case> 67g |
| Material : <Hearing Aid> ABS / <Rechargeable Case> ABS |
| <AC Adapter> ABS / <Earbud> Sillicone |